



## 5 West Street, Clay Cross, Chesterfield, S45 9QX

£525 Per Month

- First Floor Apartment
- Convenient Location
- Bedroom
- UNFURNISHED
- Well Presented
- Lounge
- Bathroom
- Modern Style
- Fitted Kitchen
- Parking Available

GROUND FLOOR  
399 sq.ft. (37.1 sq.m.) approx.

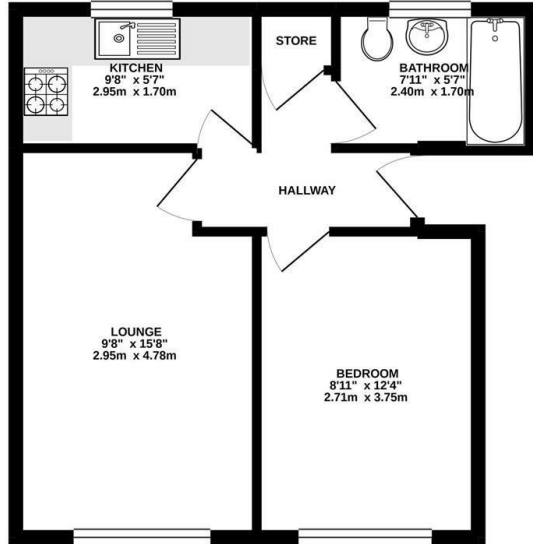

TOTAL FLOOR AREA: 399 sq.ft. (37.1 sq.m.) approx.  
Whilst every attempt has been made to ensure the accuracy of the floorplan contained herein, measurements of doors, windows, rooms and any other items are approximate and no responsibility is taken for any error, omission or misstatement. This plan is for illustrative purposes only and should be used as such by any prospective purchaser. The services, systems and appliances shown have not been tested and no guarantee as to their operability or efficiency can be given. Made with Metropix (2022)

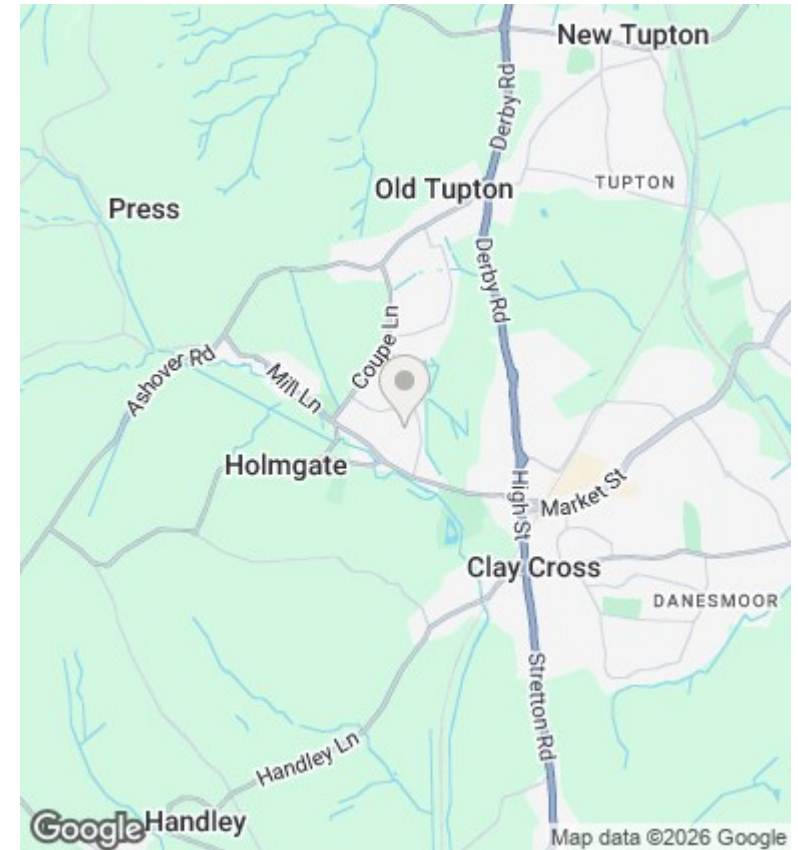

## Directions

## Viewings

Viewings by arrangement only. Call 01246 275 559 to make an appointment.

## Council Tax Band

A

## EPC Rating:

C

Energy Efficiency Rating		Current	Potential
<i>Very energy efficient - lower running costs</i>			
(92 plus)	A		
(81-91)	B		
(69-80)	C	74	76
(55-68)	D		
(39-54)	E		
(21-38)	F		
(1-20)	G		
<i>Not energy efficient - higher running costs</i>			
<b>England &amp; Wales</b>		EU Directive 2002/91/EC	